

**Rondella**  
→ Cylindrical, straight

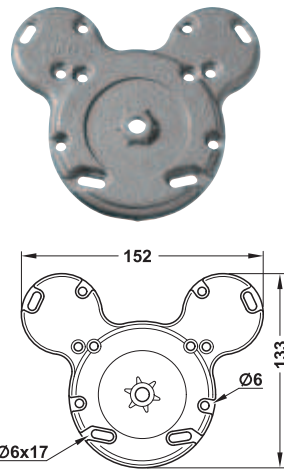

- > Area of application: For laminated table top (thickness 25–40 mm), reliable connection of leg with plate, for heavy duty use
- > Material: Glide: Plastic, screw-on plate: Zinc alloy
- > Colour: Glide: Black, screw-on plate: Grey
- > Height adjustment: +25 mm
- > Installation: For screw fixing with screw-on plate

**Supplied with**  
1 Table leg  
Fixing material

Installation height mm	Diameter mm	Finish	Cat. No.
710	60	Stainless steel coloured	635.57.072
		Polished chrome plated	635.57.272
		Black	635.57.372
		White aluminium, RAL 9006	635.57.972

Packing: 1 or 4 pieces

**Order reference**  
Please order mounting tool separately.

Table and Furniture Base Fittings

**Functionality**

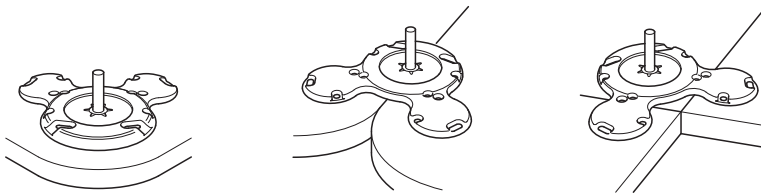

**Installation**



→ **Mounting tool**



- > Length: 200 mm
- > Diameter: 8 mm

Material	Finish	Cat. No.
Steel	Chrome plated	635.57.000

Packing: 1 piece

12

