

Glass door pivot hinge

Internal pivot, opening angle max. 130°



For all-glass constructions



For glass/wood constructions

- > Material: Stainless steel
- > Finish: Satin
- > For glass thickness: 6–10 mm
- > Load bearing capacity: Max. 5.5 kg
- > Glass thickness 6 mm: Opening angle 120°
- > Glass thickness 8 mm: Opening angle up to max. 125°
- > Glass thickness 10 mm: Opening angle up to max. 130°

→ For all-glass constructions

For inset doors

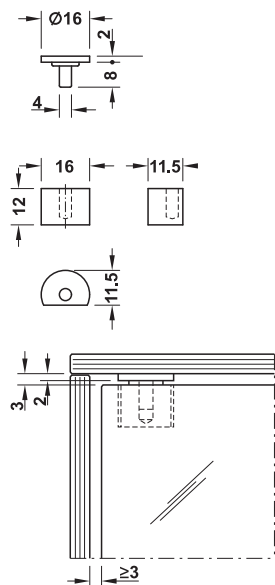

- > Installation: For glue fixing (UV glass adhesive bond)

	Cat. No.
For all-glass constructions	361.51.020

Packing: 1 pair

→ For glass/wood constructions

For inset doors

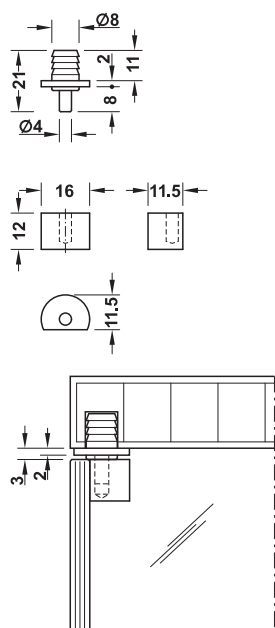

- > Installation: Door: For glue fixing (UV glass adhesive bond), cabinet: For press fitting

	Cat. No.
For glass/wood constructions	361.61.020

Packing: 1 pair

DGH-M 2017, HDE-en, 10/16; Dimensional data not binding. We reserve the right to alter specifications without notice.