

Rondella

→ Table legs, straight



- > Colour and shape combinations of table legs and screw-on plates possible
- > Different positions of table leg on screw-on plate possible



- > Material: Steel
- > Installation height: 705 mm
- > Height adjustment: +5 mm

Supplied with

- 1 Table leg
- Fixing material for screw-on plate



Square,  
white aluminium, RAL 9006



Rectangular,  
polished chrome plated

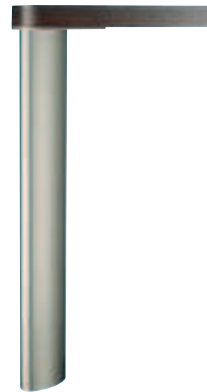

Elliptical,  
brushed nickel plated

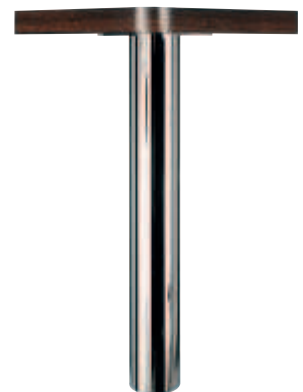

Round,  
polished chrome plated

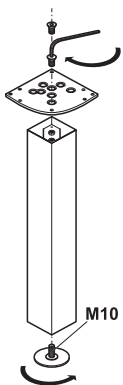

Screw-on plate not supplied.

Cross section mm	Finish/colour	Cat. No.
<b>Square</b>		
100 x 100	Polished chrome plated	635.67.204
	Brushed nickel plated	635.67.604
	White aluminium, RAL 9006	635.67.904
<b>Rectangular</b>		
100 x 50	Polished chrome plated	635.67.214
	Brushed nickel plated	635.67.614
	White aluminium, RAL 9006	635.67.914
<b>Elliptical</b>		
101 x 50.8	Polished chrome plated	635.67.224
	Brushed nickel plated	635.67.624
	White aluminium, RAL 9006	635.67.924
<b>Round</b>		
Ø 102	Polished chrome plated	635.67.234
	Brushed nickel plated	635.67.634
	White aluminium, RAL 9006	635.67.934

Packing: 1 piece

Order reference

Please order screw-on plate or fixing plate separately.



→ Accessories

Screw-on plate

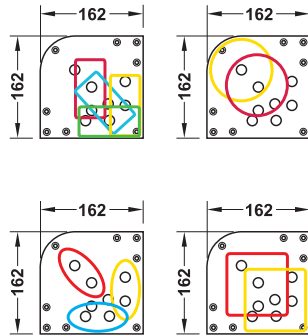

- > Area of application: For screw fixing table legs using different mounting options
- > Material: Steel
- > Installation height: 5 mm
- > Cross section: 162 x 162 mm, one corner rounded, radius 54 mm

**Supplied with**  
Installation instructions

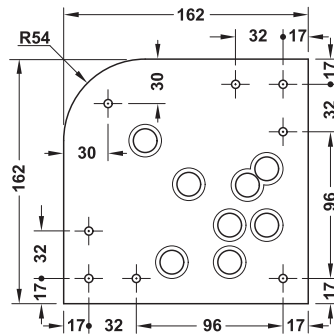

Finish/colour	Cat. No.
Polished chrome plated	635.67.290
Brushed nickel plated	635.67.690
White aluminium, RAL 9006	635.67.990

Packing: 1 piece

Fixing plate

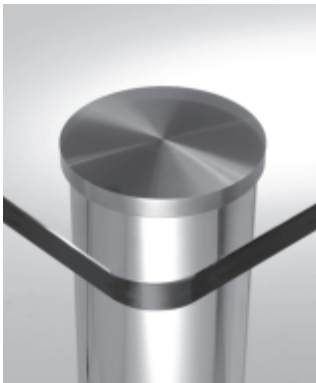

- > Area of application: For mounting table legs to glass or stone table tops
- > Material: Aluminium
- > Installation height: 15 mm
- > Cross section: Ø 110 mm
- > Version: With M10 threaded pin

**Note**

The fixing plate can only be used for round table legs.

	Cat. No.
Fixing plate	635.67.991

Packing: 1 piece

