

→ **Load bearing capacity up to 25 kg**  
Single extension, two-way travel, runner width 37 mm

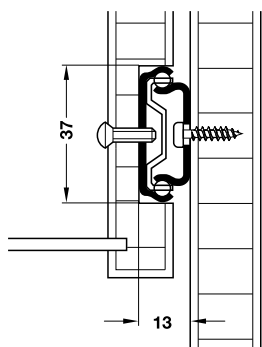

- > Material: Steel
- > Finish: Galvanized
- > Bearing: 2 ball cages
- > Dim.: Max. drawer width = internal cabinet width – 26 mm + double groove depth
- > Installation: Groove mounted on drawer

### Installation



Secure guide rail in drawer groove using an M4 threaded screw.



### Drilling pattern

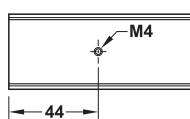
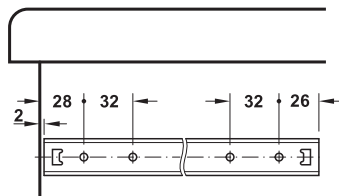

Drawer rail

Installation length L mm	Drawer length SL mm	Cat. No.
292	300–480	420.96.300
342	350–580	420.96.350

Packing: 1 or 10 pairs

Type of runner, type of mounting, load bearing capacity, installation, dimensions and functionality ▶ FF 8.122

Soft and controlled closing mechanism ▶ FF 8.133

## Accuride DZ 2431, full extension

Load bearing capacity up to 20 kg



- > Version: Runner height 20 mm
- > Material: Steel
- > Finish: Galvanized
- > Dim.: Max. drawer width = internal cabinet width – 32 mm
- > Installation: At drawer, side mounted (surface mounted installation not recommended)

### Installation

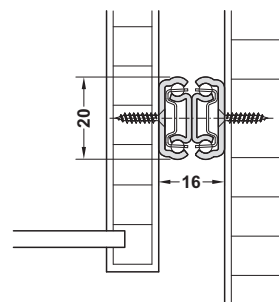

Hospa wood screw: Max. head height 1.8 mm, Ø 5.6 mm

### Drilling pattern

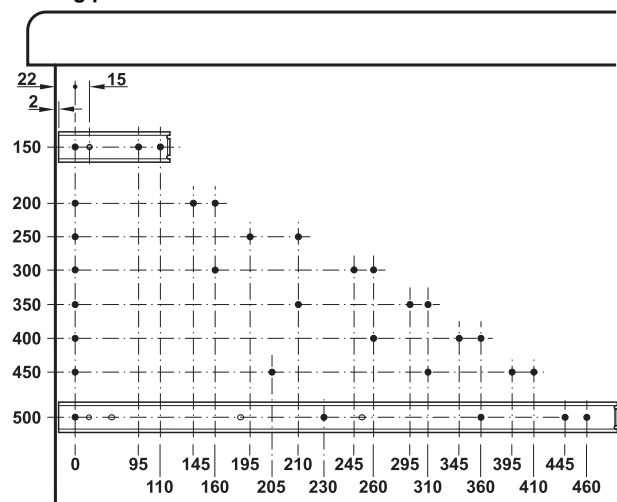

Installation length mm	Extension length mm	Load bearing capacity kg	Packing pairs	Cat. No.
150	156	15	1 or 20	432.30.915
200	231	17	1 or 10	432.30.920
250	280	19	1 or 10	432.30.925
300	329	20	1 or 10	432.30.930
350	379	20	1 or 10	432.30.935
400	428	18	1 or 10	432.30.940
450	477	16	1 or 10	432.30.945
500	526	13	1 or 10	432.30.950

DGH-M-INT 2020, HDE-en, 05/19; Dimensional data not binding. We reserve the right to alter specifications without notice.