

## Häfele Slido D-Line11 50I to 120I Sliding door fitting



### Soft and self closing mechanism:

- > Low opening force – easy and convenient operation
- > Tested with increased speed up to 0.5 m/s
- > Can be retrofitted or replaced at any time

### Shock absorber:

- > Closing speed with shock absorber tested up to 0.4 m/s



- > Suitable for: For wooden doors
- > Area of application: For 1-leaf and 2-leaf sliding doors
- > Door weight: ≤50/80/120 kg
- > Adjustment facility: Door height adjustable ±3 mm
- > Installation: Wall mounting and ceiling installation, suspension with integrated support flange

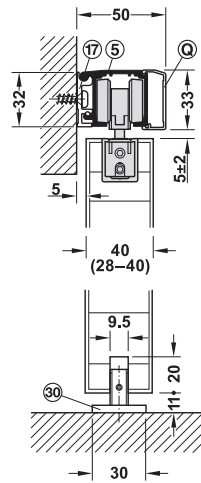

Section guide and trolley hanger

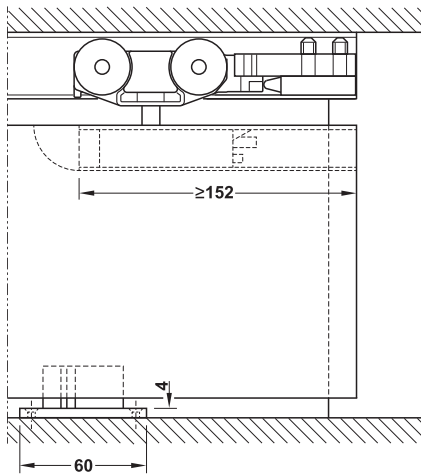

Routing dimensions

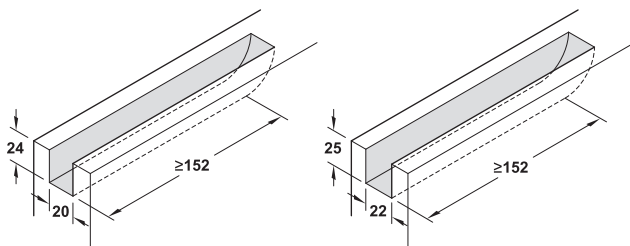

50I

80I and 120I

Wall mounting with mounting rail and clear threshold floor guide without guide track

### Soft closing versions overview

#### Running gear with axle bearing

Without soft and self closing mechanism

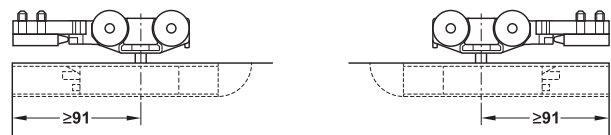

With soft and self closing mechanism on one side

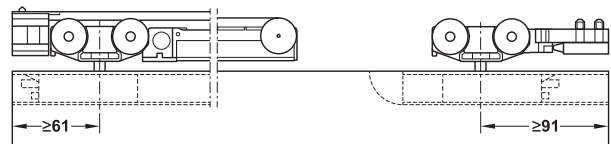

#### Running gear with ball bearing mounted rollers

With with soft and self closing mechanism on one side and shock absorber

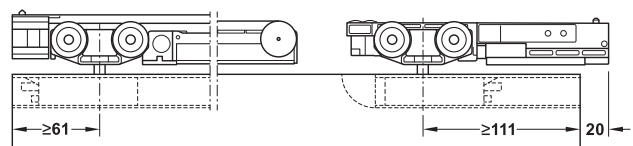

With soft and self closing mechanism on both sides

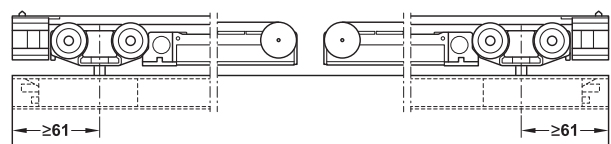

## → Set with running track for 1 door

Wall mounting with mounting rail

Version		Supplied with	Door width mm	80l ≤80 kg per door
<b>Running gear with axle bearing</b>				
Without soft and self closing mechanism	Track buffer with retaining spring	1 80l set 1 mounting rail ⑰ 2000 mm 1 running track ⑤ 2000 mm with threaded end inserts 1 panel 2000 mm with end caps	≥500	940.83.068
With soft and self closing mechanism on one side	Track buffer with retaining spring	1 80l set 1 mounting rail ⑰ 2000 mm 1 running track ⑤ 2000 mm with threaded end inserts 1 panel 2000 mm with end caps	≥499	940.83.069
<b>Running gear with ball bearing mounted rollers</b>				
With soft and self closing mechanism on one side	Shock absorber with retaining spring	1 80l set 1 mounting rail ⑰ 2000 mm 1 running track ⑤ 2000 mm with threaded end inserts 1 panel 2000 mm with end caps	≥538	940.83.070
With soft and self closing mechanism on both sides	–	1 80l set 1 mounting rail ⑰ 2000 mm 1 running track ⑤ 2000 mm with threaded end inserts 1 panel 2000 mm with end caps	≥744	940.83.071

## → Set without running track for 1 door

Version		Supplied with	Door width mm	50l ≤50 kg per door	80l ≤80 kg per door	120l ≤120 kg per door
<b>Running gear with axle bearing</b>						
Without soft and self closing mechanism	Track buffer with retaining spring	2 running gears with support flange 2 support profiles with cover cap 1 clear threshold floor guide 2 track buffers with retaining spring	≥500	940.44.004	940.83.053	941.25.044
With soft and self closing mechanism on one side	Track buffer with retaining spring	2 running gears with support flange (1 with soft and self closing mechanism) 2 support profiles with cover cap 1 clear threshold floor guide 1 track buffer with retaining spring 1 release device with stopper for soft and self closing mechanism	≥499 (50 and 80 kg) ≥561 (120 kg)	940.44.005	940.83.054	941.25.045
<b>Running gear with ball bearing mounted rollers</b>						
With soft and self closing mechanism on one side	Shock absorber with retaining spring	2 running gears with support flange (1 with soft and self closing mechanism) 2 support profiles with cover cap 1 clear threshold floor guide 1 shock absorber with retaining spring 1 release device with stopper for soft and self closing mechanism	≥538 (50 and 80 kg) ≥600 (120 kg)	940.44.006	940.83.055	941.25.046
With soft and self closing mechanism on both sides	–	2 running gears with support flange and soft and self closing mechanism 2 support profiles with cover cap 1 clear threshold floor guide 2 release devices with stopper for soft and self closing mechanism	≥744 (50 and 80 kg) ≥868 (120 kg)	940.44.007	940.83.056	941.25.047

### Order reference

Please order track, panels and accessories separately. Order 2 sets for 2-leaf sliding doors.

Please order adjustment aid for adjusting the running gears (height and position) separately.

### Note

Please note when using the shock absorber with retaining spring: The door may not close completely if the closing speed is too low, it is too high, the door may bounce back slightly. Sets without or with soft and self closing mechanism on one side can be retrofitted with soft and self closing mechanism or shock absorber, if required.

## → Accessories for retrofitting

		Load bearing capacity kg	Cat. No.
Soft and self closing mechanism, with release device with stopper, for clamping onto running gear		50	940.42.304
		80	940.83.300
		120	941.02.300
Shock absorber with retaining spring, for clamping onto running gear		50	940.42.305
		80	940.83.301
		120	941.02.301

## Fixing options for Häfele Slido D-Line11 50l to 120l Sliding door fitting

### Wall mounting with mounting rail

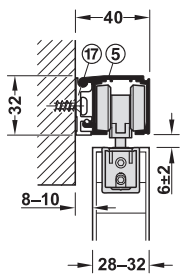

With running track ⑤, mounting rail ⑰ width 8 mm

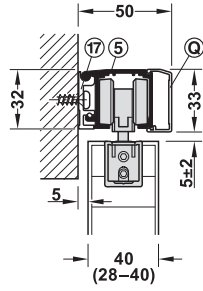

With running track ⑤, mounting rail ⑰ width 8 mm and clip panel ①

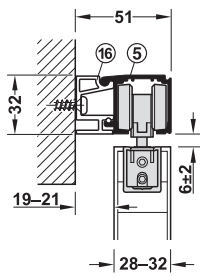

With running track ⑤, mounting rail ⑰ width 19 mm

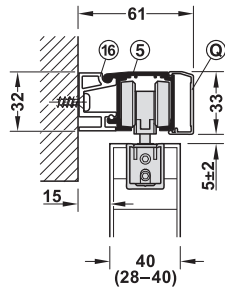

With running track ⑤, mounting rail ⑰ width 19 mm and clip panel ①

### Ceiling installation

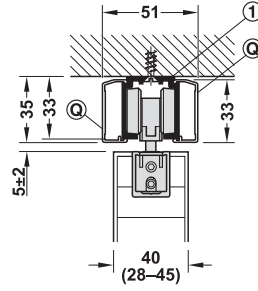

With running track ① and 2 x clip panel ①

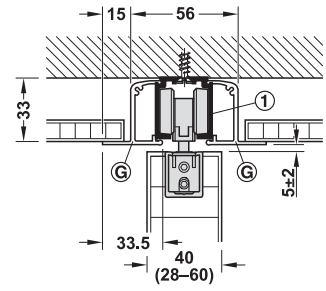

With running track ① and 2 x clip panel ①

### Guides

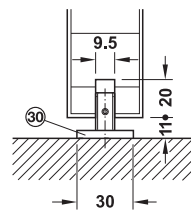

Clear threshold floor guide ③①, without guide track

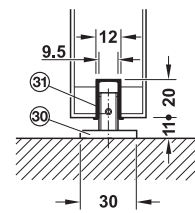

Clear threshold floor guide ③①, with guide track ③②