

Wire hook

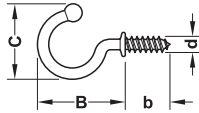

- > Version: With rounded tip
- > Material: Stainless steel, quality 1.4301/AISI 304
- > Finish: Polished

Depth B mm	Height C mm	Diameter D mm	Thread length b mm	Packing pieces	Cat. No.
16.8	15	2.7	11	1 or 200	856.00.003
22.8	20	2.7	11	1 or 100	856.00.004
29.2	25	3.5	15	1 or 50	856.00.005
40.5	34	4.5	20	1 or 50	856.00.006

Swivel hook

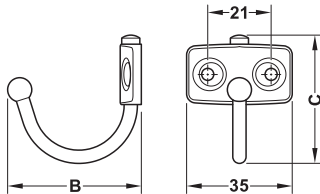

- > Version: Positive-fitting, swivels by 180°
- > Material: Stainless steel, quality 1.4301/AISI 304
- > Finish: Polished
- > Hole spacing: 21 mm
- > Fixing material supplied (chipboard screws \varnothing 3.5 x 20 mm)

Width A mm	Depth B mm	Height C mm	Cat. No.
35	36	38	856.00.001
35	44.3	43	856.00.002

Packing: 1 or 100 pieces

Rotating swivel hook

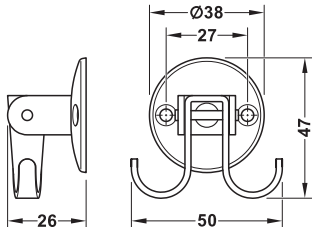

- > Area of application: Also suitable for use as ceiling hook, e.g. beneath bar tables
- > Version: Rotates through 360°, swivels by 180°
- > Material: Stainless steel, quality 1.4301/AISI 304
- > Finish: Satin
- > Hole spacing: 27 mm
- > Rose \varnothing E: 38 mm
- > Fixing material supplied (chipboard screws \varnothing 3.0 x 25 mm)

Width A mm	Depth B mm	Height C mm	Cat. No.
50	26	47	856.00.000

Packing: 1 or 25 pieces

DGH-M 2018, HIDE-en, 06/18; Dimensional data not binding. We reserve the right to alter specifications without notice.