

V 5450 Drill-in hinge, rising

For rebated doors up to 40 kg, for wooden frames

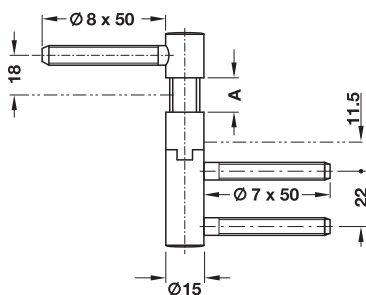
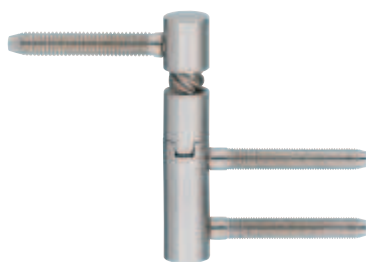

A = 6 mm with 90° opening angle

- Area of application: For wooden frames, for rebated wooden interior doors
- Door weight: ≤40 kg
- Knuckle Ø: 15 mm
- Drill bit Ø : Wing part 6.8 mm, frame part 7.2 mm
- For use in combination with receiver

Installation

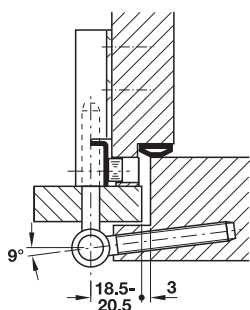

Material	Finish	DIN left	DIN right
Steel	Nickel plated	922.11.770	922.11.870

Order reference

Following items are available on request:
Mounting aid VARIANT V 0020/V 0026 WF series drilling jig.

Mounting aid VARIANT plastic drilling jig	► BB 6.58
Receiver for lining frames, screw-on pocket of VARIANT V 3610 series	► BB 6.41
Receiver for block frames and blind frames, VARIANT V 3604, V 3605 clamping block	► BB 6.41
Receiver for lining frames, block frames and blind frames, VARIANT V 3607 clamping block	► BB 6.42

V 8550 Drill-in hinge, rising

For rebated doors up to 40 kg, for steel frames

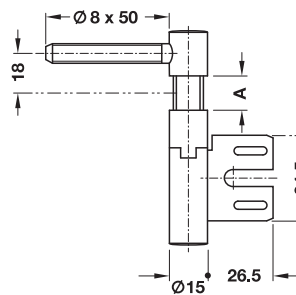
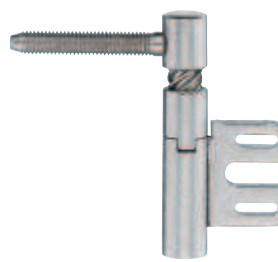

A = 6 mm with 90° opening angle

- Area of application: For steel frames with VARIANT V 8600, V 8610 or V 8618 weld-on pockets, for rebated wooden interior doors
- Door weight: ≤40 kg
- Knuckle Ø: 15 mm
- Drill bit Ø : Wing part 6.8 mm

Installation

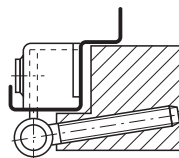

Material	Finish	DIN left	DIN right
Steel	Nickel plated	922.23.571	922.23.671

Order reference

Following items are available on request:
Mounting aid VARIANT V 0020/V 0026 WF series drilling jig.

Mounting aid VARIANT plastic drilling jig	► BB 6.58
-------------------------------------------	-----------



6

Drill-In Hinges and Recessed Hinges