

→ Spacer ring

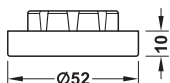

Note

The use of several spacer rings is possible if secure stability is provided.

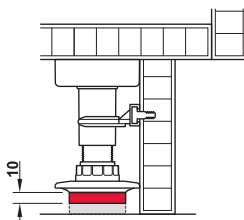

- > Area of application: For increasing the height of the screw-in glides by 10 mm
- > Material: Plastic
- > Installation: For plug fitting into the screw-in glide from below

| Colour | Cat. No. |
|--------|------------|
| Black | 637.76.422 |

Packing: 1, 20 or 100 pieces

→ ABS insert

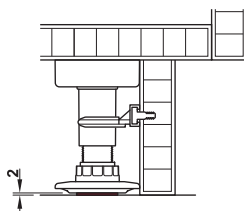
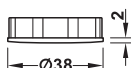

- > Area of application: For sensitive floors and heavy constructions
- > Material: Plastic
- > Installation: For plug fitting into the screw-in glide from below
- > Functionality: Increases the height adjustment facility from 80 to 110 kg

| Colour | Cat. No. |
|--------|------------|
| Grey | 637.76.423 |

Packing: 20 or 100 pieces

→ Acoustic insulation

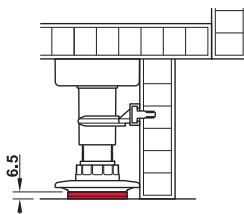
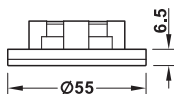

- > Area of application: For acoustic insulation
- > Material: Plastic
- > Installation: For plug fitting into the screw-in glide from below
- > Functionality: Reduces sound transmission of electrical appliances through cabinets to the floor

| Colour | Cat. No. |
|--------|------------|
| Grey | 637.76.424 |

Packing: 20 or 100 pieces

Note

This product cannot be used in combination with the spacer ring.

→ Plinth holder

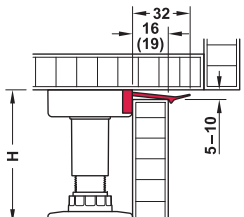

Plinth height = H - 5 to 10 mm

- > Area of application: For fixing the plinth panel
- > Material: Plastic
- > Installation: For plug fitting into mounting plates

| Suitable for | Packing pieces | Cat. No. |
|--------------|----------------|------------|
| 16 mm panel | 20 | 637.47.491 |
| 19 mm panel | 1 or 20 | 637.47.490 |

→ Plinth panel clips

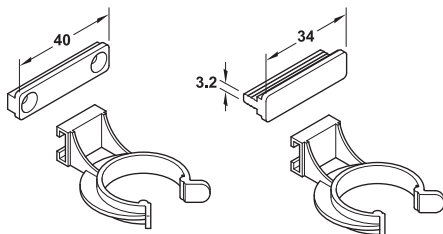

For screw fixing

For press fitting

For knocking in

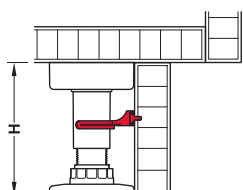

- > Material: Plastic

| Installation | Cat. No. |
|--|------------|
| For screw fixing | 637.38.054 |
| For press fitting, for groove 3 mm | 637.38.063 |
| For knocking in with pre-mounted nails | 637.38.050 |

Packing: 20 or 100 pieces

Note

For use from installation height H = 80 mm.

| | |
|---------------------------------|-------------|
| Mounting plate | ► MB 12.111 |
| Tube with screw-in glide | ► MB 12.111 |
| Häfele AXILO™ 78 adjusting tool | ► MB 12.110 |