

### Stay flap fitting

For one-piece flaps made of wood or with aluminium frame



Wooden flap

Adjusting the opening angle by moving the restraint

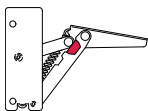

Opening angle 75°

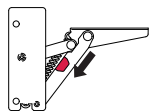

Opening angle 90°

#### Sample measurements table

Cabinet height mm	Flap weight including handle in kg	
	min.	max.
300	1.0	6.2
350	1.2	4.9
400	1.4	3.8
450	1.5	3.6
500	1.7	2.9
550	1.9	2.7
600	2.1	2.5

- > Material: Steel
- > Finish: Nickel plated or plastic coated white
- > Version: With automatic swing up and opening angle restraint
- > Adjustment facility: Spring force up to 240 N, opening angle of flap 75° or 90°, height adjustment ±1 mm
- > Installation: For screw fixing into 32 mm series drilled holes

#### Space requirement

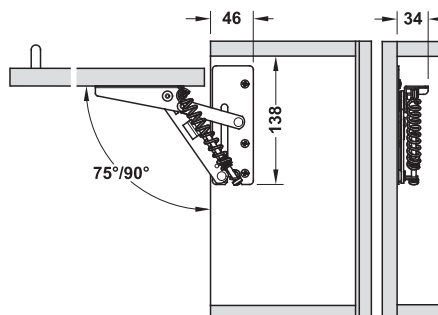

#### → For flaps made of wood or with wide aluminium frame

##### Drilling pattern for front panel

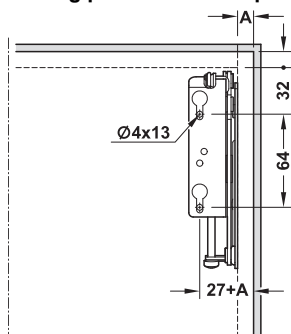

##### Drilling pattern for cabinet

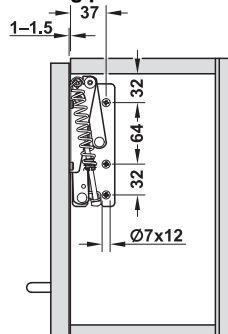

##### Supplied with

- 1 fitting left or right
- 1 set of installation instructions



Finish/colour	Mounting	Cat. No.
Nickel plated	Left	372.45.741
	Right	372.45.740
Plastic coated white	Left	372.45.710
	Right	372.45.700

Packing: 1 or 50 pieces