

Gallery rail system, round



→ Gallery rail



- > Material: Stainless steel, quality 1.4301
- > Finish: Satin brushed, or PVD coated brass coloured
- > Length: 2,500 mm solid material

Rail Ø mm	Satin brushed	Brass coloured
6	812.20.602	812.20.802
10	812.22.602	812.22.802

Packing: 1 piece

→ Gallery rail post



- > Material: Zinc alloy
- > Finish: PVD coated
- > Diameter: 10 mm (for 6 mm gallery rail) or 15 mm (for 10 mm gallery rail)

For 6 mm gallery rail

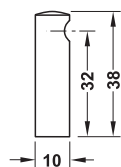

For 1 gallery rail

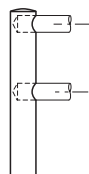

Gallery rail end post with blind hole

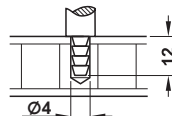

Press-fit dowel for wood

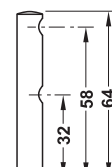

For 2 gallery rails

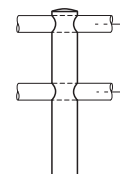

Gallery rail centre post with through hole

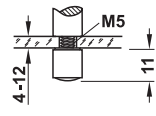

Threaded sleeve for glass



For glue fixing to glass

For 10 mm gallery rail

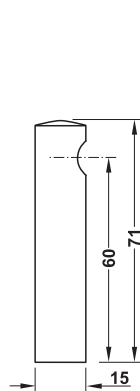

For 1 gallery rail

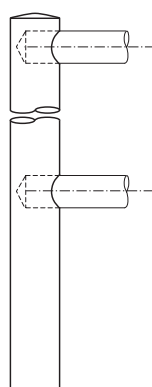

Gallery rail end post with blind hole

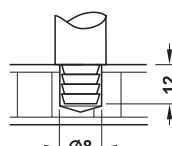

Press-fit dowel for wood

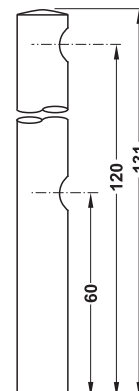

For 2 gallery rails

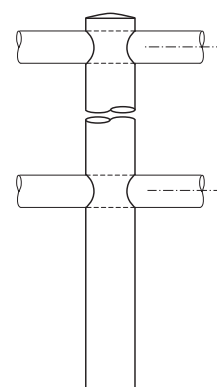

Gallery rail centre post with through hole

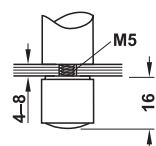

Threaded sleeve for glass

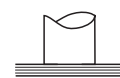

For glue fixing to glass



6

Midway Systems

Gallery rail post for 1 rail 6 mm

Installation	Stainless steel coloured	Brass coloured
With through hole as centre post		
Press-fit dowel	812.26.600	812.26.800
Threaded sleeve	812.26.601	812.26.801
With blind hole as end post		
Press-fit dowel	812.26.620	812.26.820
Threaded sleeve	812.26.621	812.26.821

Packing: 1 piece

Gallery rail post for 2 rails 6 mm

Installation	Stainless steel coloured	Brass coloured
With through hole as centre post		
Press-fit dowel	812.26.610	812.26.810
Threaded sleeve	812.26.611	812.26.811
With blind hole as end post		
Press-fit dowel	812.26.630	812.26.830
Threaded sleeve	812.26.631	812.26.831

Packing: 1 piece

Gallery rail post for 1 rail 10 mm

Installation	Stainless steel coloured	Brass coloured
With through hole as centre post		
Press-fit dowel	812.27.600	812.27.800
Threaded sleeve	812.27.601	812.27.801
With blind hole as end post		
Press-fit dowel	812.27.620	812.27.820
Threaded sleeve	812.27.621	812.27.821

Packing: 1 piece

Gallery rail post for 2 rails 10 mm

Installation	Stainless steel coloured	Brass coloured
With through hole as centre post		
Press-fit dowel	812.27.610	812.27.810
Threaded sleeve	812.27.611	812.27.811
With blind hole as end post		
Press-fit dowel	812.27.630	812.27.830
Threaded sleeve	812.27.631	812.27.831

Packing: 1 piece

Order reference

Gallery rail post with screw-on plate available on request.

→ Support ring for gallery rail 6 mm

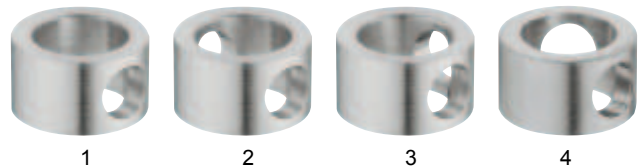

- > Area of application: For angled gallery rail systems or as design variant
- > Material: Zinc alloy
- > Finish: PVD coated

Installation dimensions

Dim. A = pitch length

Dim. B = gallery rail length

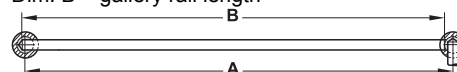

Dim. B = dim. A – 3 mm (one-sided installation on gallery rail post)

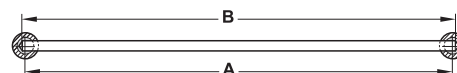

Dim. B = dim. A + 4 mm (two-sided installation on gallery rail post)

Installation

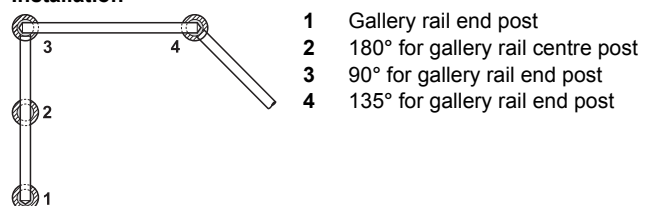

- 1 Gallery rail end post
- 2 180° for gallery rail centre post
- 3 90° for gallery rail end post
- 4 135° for gallery rail end post

Version	Stainless steel coloured	Brass coloured
For rail 6 mm		
Gallery rail end post	812.27.870	812.26.870
180° for gallery rail centre post	812.27.860	812.26.860
90° for gallery rail end post	812.27.840	812.26.840
135° for gallery rail end post	812.27.850	812.26.850

Packing: 1 piece

Gallery rail system, square

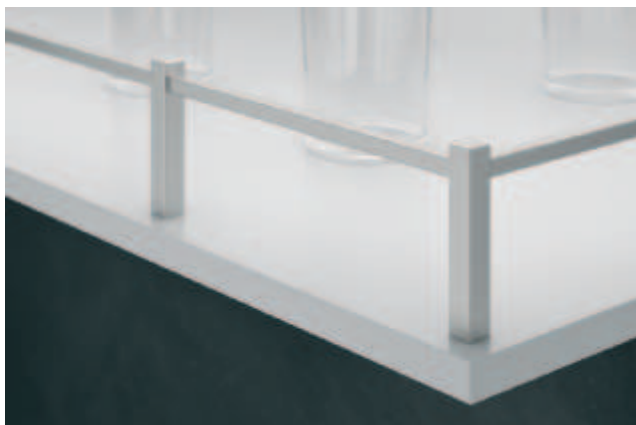

- > Material: Stainless steel, quality 1.4301
- > Finish: Satin brushed

→ Gallery rail

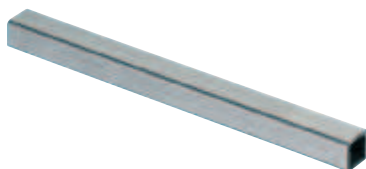

- > Length: 2,500 mm
- > Version: Square tube 8 x 8 mm
- > Wall thickness: 1 mm

	Cat. No.
Gallery rail	812.28.002

Packing: 1 piece

→ Gallery rail post

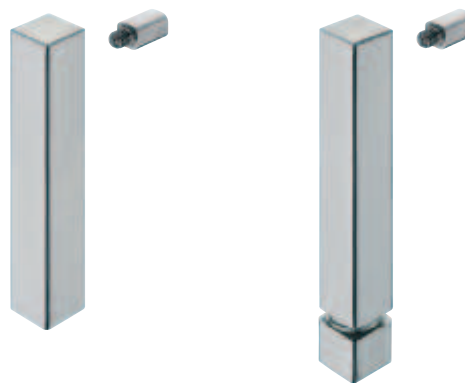

Gallery rail end post for wood Gallery rail end post for glass

- > Installation: The gallery rail is glued onto the screw-in part

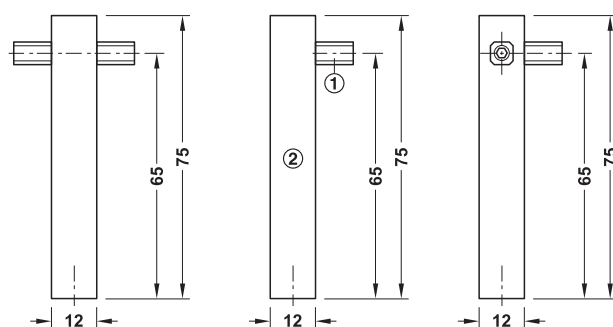

Gallery rail centre post Gallery rail end post
① Screw-in part ② Post Gallery rail corner post 90°

Installation

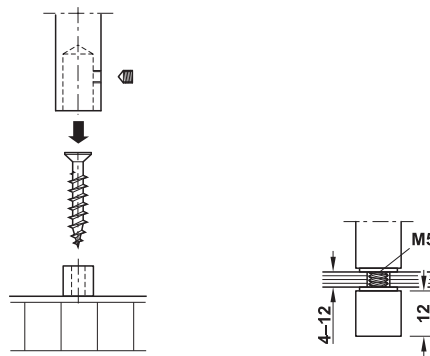

For mounting on wood

Threaded sleeve for mounting on glass

	Cat. No.
Gallery rail centre post	
Wood	812.29.010
Glass	812.29.011
Gallery rail end post	
Wood	812.29.000
Glass	812.29.001
Gallery rail corner post 90°	
Wood	812.29.020
Glass	812.29.021

Packing: 1 piece

Adhesive for metal

► FF 12.83



6

Midway Systems

Gallery rail system



→ Gallery rail



> Material:	Steel
> Length:	1,000 mm
> Rail Ø:	6 mm

Finish/colour	Cat. No.
Polished chrome plated	522.15.219

Packing: 1 piece

→ Gallery rail, angled

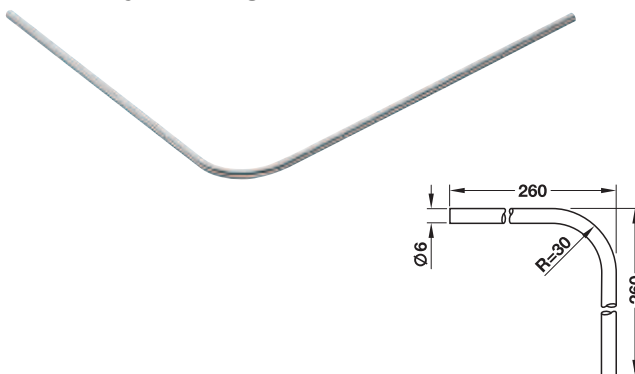

> Material:	Steel
> Length:	Side length: 260 mm

Finish/colour	Cat. No.
Polished chrome plated	522.16.216

Packing: 1 piece

→ Gallery rail post with decorative finial

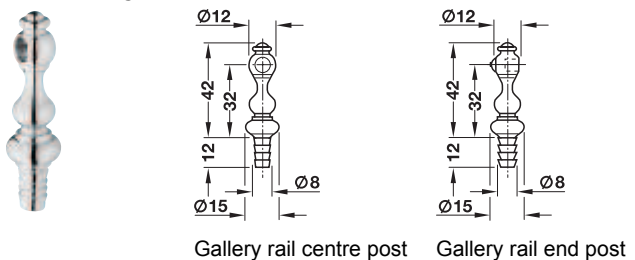

> Material:	Zinc alloy
> Installation:	For press fitting

Finish/colour	Gallery rail centre post	Gallery rail end post
Polished chrome plated	522.17.213	522.17.222

Packing: 1 or 10 pieces

→ Gallery rail post straight

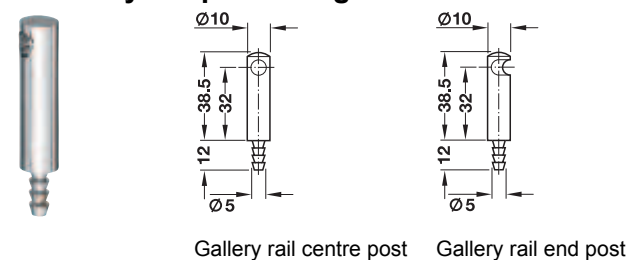

> Material:	Zinc alloy
> Installation:	For press fitting

Finish/colour	Gallery rail centre post	Gallery rail end post
Polished chrome plated	522.17.234	522.17.244

Packing: 1 or 10 pieces

DGH-M-INT 2020, HDE-en, 05/19; Dimensional data not binding. We reserve the right to alter specifications without notice.

Breakfast bar supports for mounting on worktops or furniture

→ Kesseböhmer, straight, round

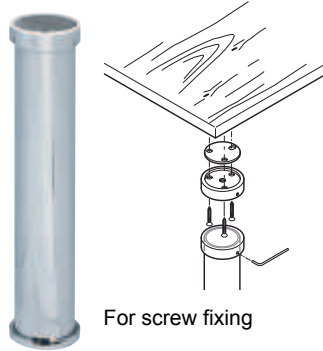

- > Material: Steel
- > Load bearing capacity: 15 kg, with 600 mm distance and 200 mm overhang (projection)
- > Installation: For screw fixing or glue fixing, e.g. on glass

Supplied with
Fixing material

Installation	Matt chrome plated	Polished chrome plated	Matt nickel plated
For screw fixing	505.15.400	505.15.200	505.15.600
For glue fixing	505.15.401	505.15.201	505.15.601

Packing: 1 piece

Note

Installation "for glue fixing" only applies to the top connection, the bottom connection is always screwed.

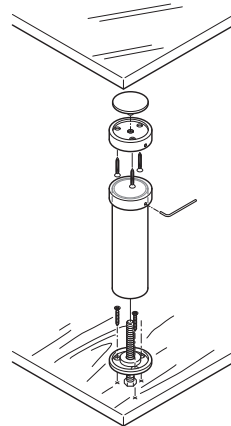
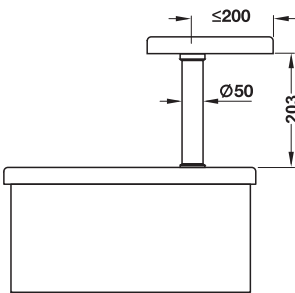

6

Midway Systems

→ Kesseböhmer, inclined, round

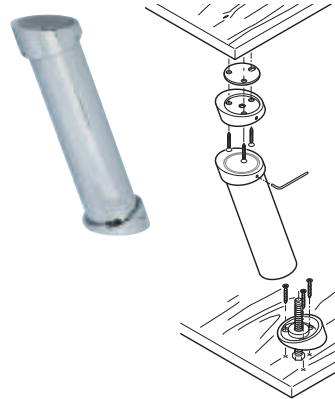

- > Material: Steel
- > Load bearing capacity: 15 kg, with 600 mm distance and 200 mm overhang (projection)
- > Installation: For screw fixing or glue fixing, e.g. on glass

Supplied with
Fixing material and installation instructions

Installation	Matt chrome plated	Polished chrome plated	Matt nickel plated
For screw fixing	505.15.410	505.15.210	505.15.610
For glue fixing	505.15.411	505.15.211	505.15.611

Packing: 1 piece

Note

Installation "for glue fixing" only applies to the top connection, the bottom connection is always screwed.

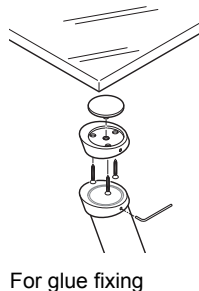
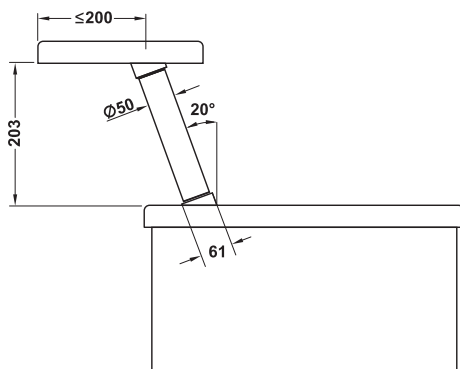

Glass gluing technique

► FF 13.5

DGH-M-INT 2020, HDE-en, 05/19; Dimensional data not binding. We reserve the right to alter specifications without notice.