

Pivot hinge for writing bureau for special applications



- > Reinforced version for heavy loads
- > Three versions to suit different flap heights



- > Area of application: For folding tables, additional work surfaces or luggage racks in hotels
- > Material: Stainless steel
- > Finish: Ground
- > Opening angle: 90°
- > Flange thickness: 5 mm
- > For flap width: ≤1,200 mm
- > Installation: For screw fixing

**Note**

The specified load bearing capacities only apply under following conditions:

- > With static loads placed in the centre
  - > When using dimensionally stable material, e.g. veneer plywood
- Less projection allows higher loads. In this case trial mounting is required!



4

Flap Stays

**Order reference**

Please order fixing material separately.

**Supplied with**

1 pair (1 aperture part each left and right, 1 pivot part each left and right)

→ **Load bearing capacity 40 kg**

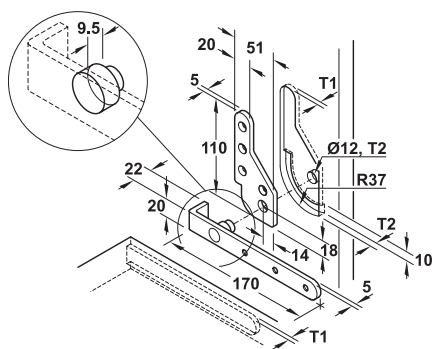

Recess depth  
T1 = 5 mm,  
T2 = 8 mm

For flap height mm	Cat. No.
≤400	361.50.830

Packing: 1 piece

→ **Load bearing capacity 60 kg**

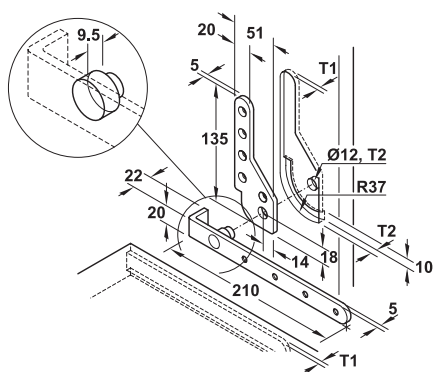

Recess depth  
T1 = 5 mm,  
T2 = 8 mm

For flap height mm	Cat. No.
≤500	361.50.831

Packing: 1 piece

→ **Load bearing capacity 70 kg**

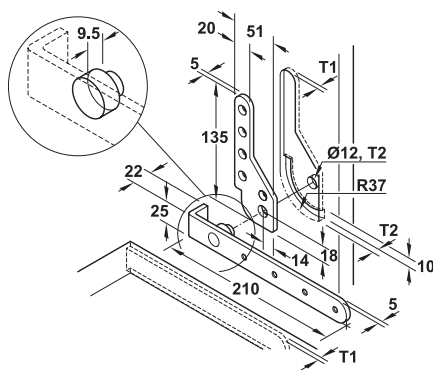

Recess depth  
T1 = 5 mm,  
T2 = 8 mm

For flap height mm	Cat. No.
≤600	361.50.832

Packing: 1 piece

Stainless steel screws, countersunk head, TS

► FF 13.23

DGH-M-INT 2020, HDE-en, 05/19; Dimensional data not binding. We reserve the right to alter specifications without notice.